

Luminaire Overview

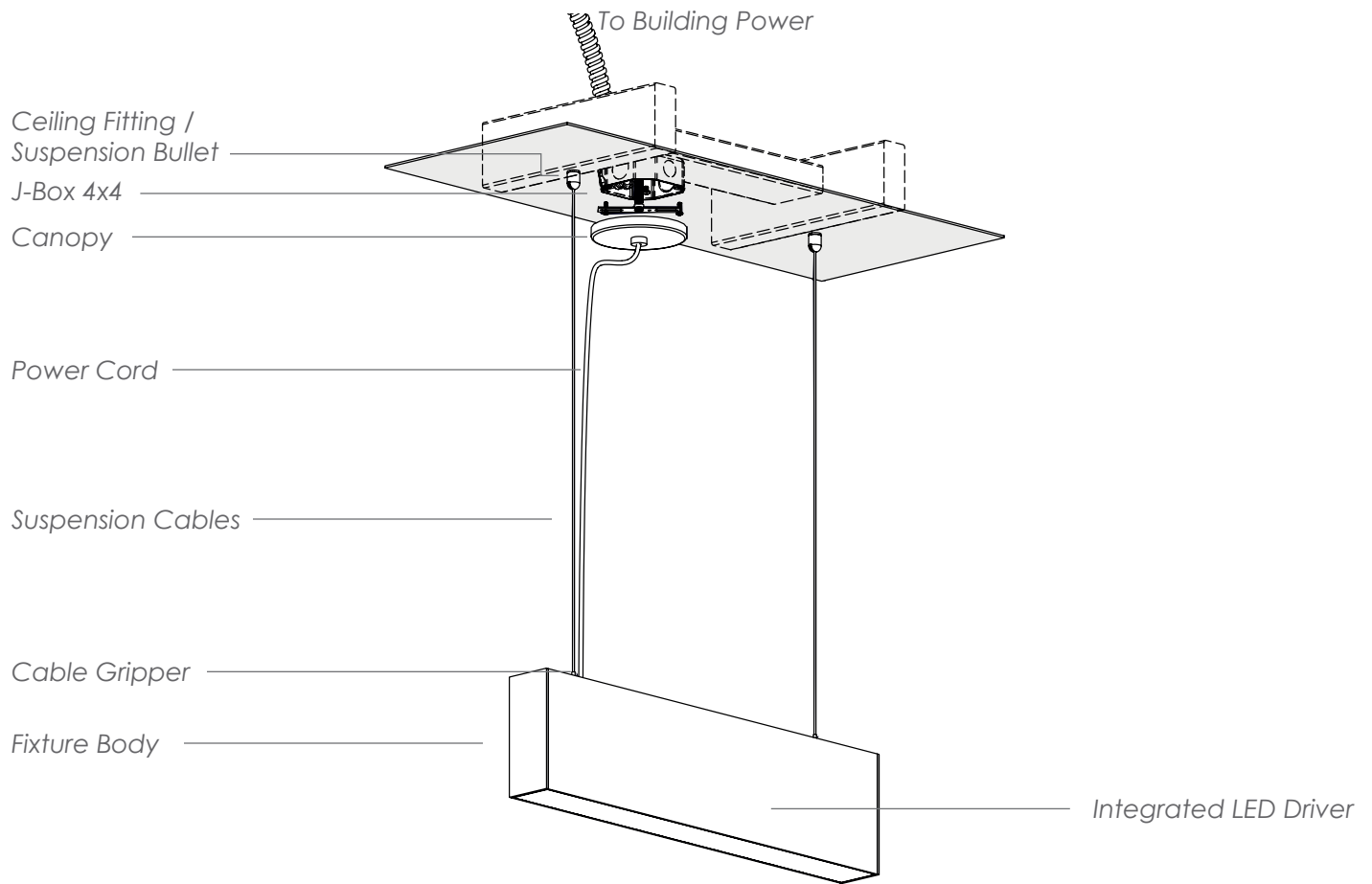

STANDARD SUSPENSION COMPONENTS

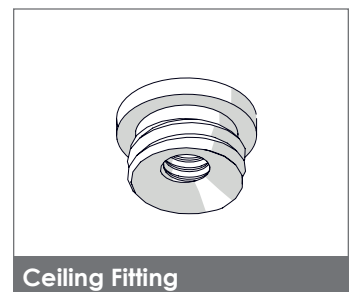
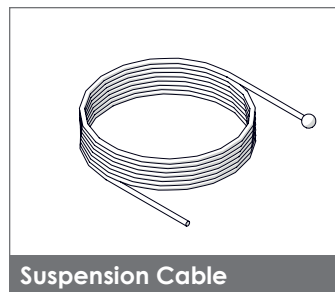
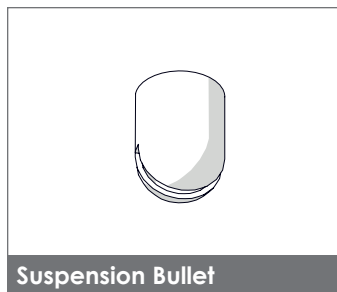
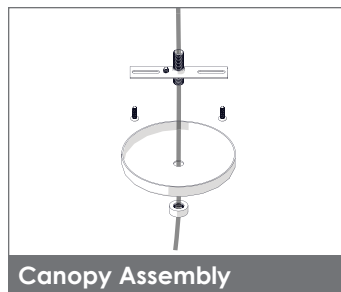

Parts (by others)

- Junction Box 4x4(Optional)
- Wood Screws, #10, 1.5" long
- Conduit/NM (non-metallic) cable (or similar) if not using J-Box

Tools Required

- Drill
- #2 phillips bit
- Wire strippers
- 5/64" Hex Key (for Joining)
- 1/8" Hex Key (for Joining)

Quick Specs

Input Voltage / Frequency:
See product label

Rated Power:
See product drawing

Ambient Temperature:
-4° – 120°F (-20° – 50°C)

Environment:
Dry and damp locations

Installation: Prepare Ceiling

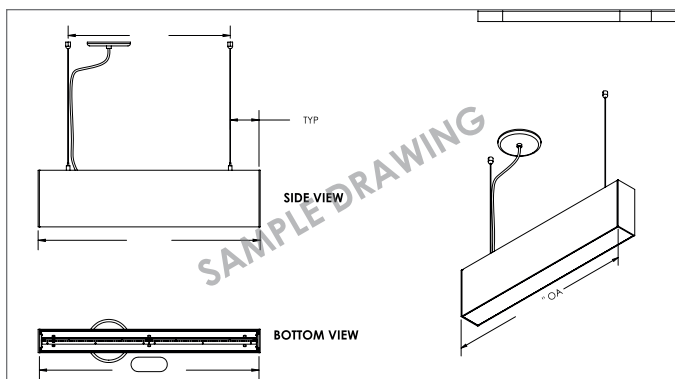

1 See Final/Record Drawings for Mounting Locations

See final/record drawings for mounting locations. Install framing or strut channels with consideration for alignment of wiring and suspension mounting locations.

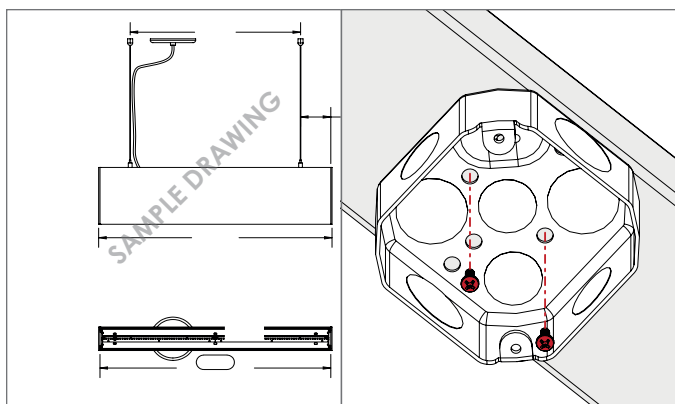

2 Install Canopy J-Box

Install Canopy J-Box (if using - sold separately) at power feed location per final/record drawing. Otherwise run conduit/NM cable to Powerfeed Location.



SHOCK HAZARD! May result in serious injury or death. Turn power OFF at circuit breaker prior to installation or servicing.



DO NOT PINCH OR PUT EXCESSIVE TENSION ON WIRES while joining sections or reattaching heatsink.

Installation: Standard Suspension

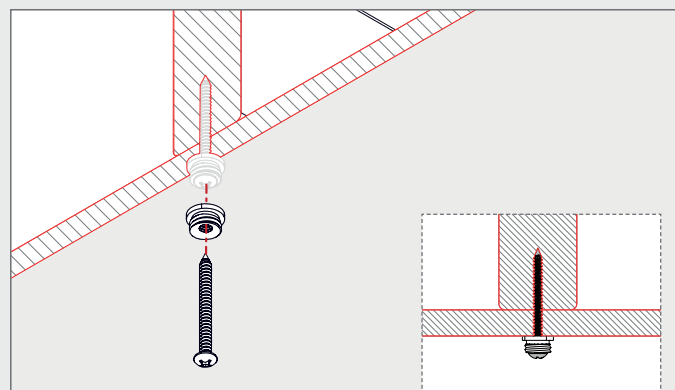

3A Install Ceiling Fitting - Framing

Ceiling Fittings may be installed directly into framing with appropriate hardware.

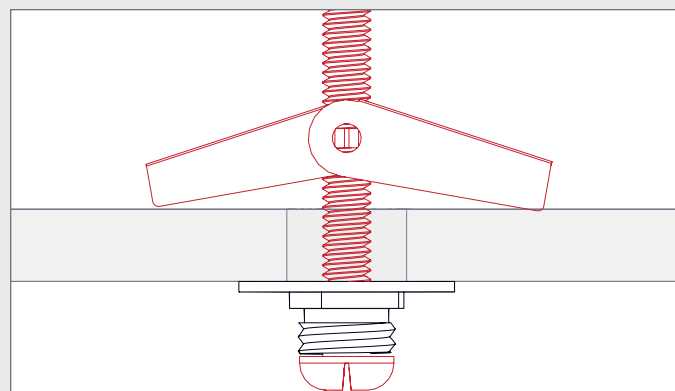

3B Install Ceiling Fitting - Toggle Bolts

Ceiling Fittings may also be mounted using toggle bolts.

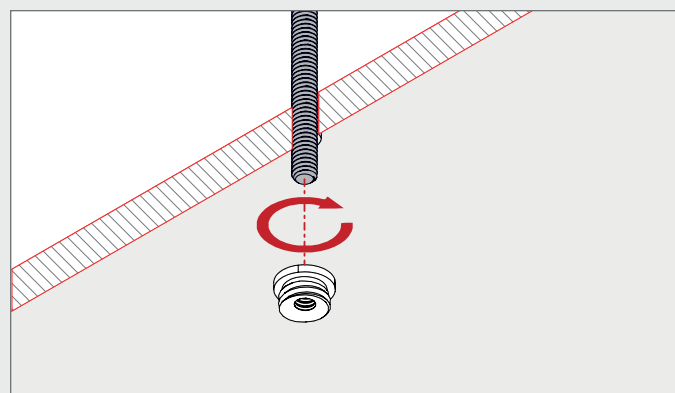

3C Install Ceiling Fitting - 1/4"-20 Threaded Rods

Ceiling Fittings may also be mounted on 1/4"-20 Threaded Rods.

Installation: Standard Suspension (Cont.)

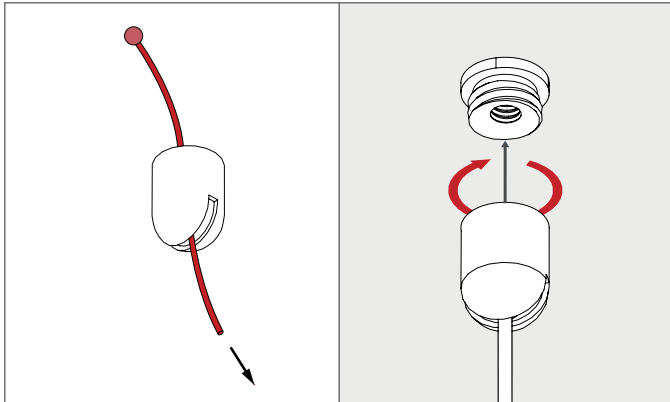

4 Route Suspension Cable and Attach to Ceiling

Route Suspension Cable through Suspension Bullet. Ball end should sit in Suspension Bullet. Screw Suspension Bullet to Ceiling Fitting.

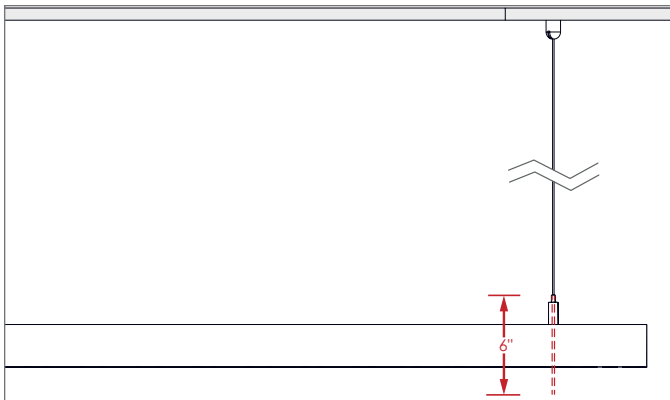

5 Cut Suspension Cables to Desired Length

Use wire snips or shears to cut Suspension Cables to desired length. Keep an extra 6 inches of cable for adjustments.

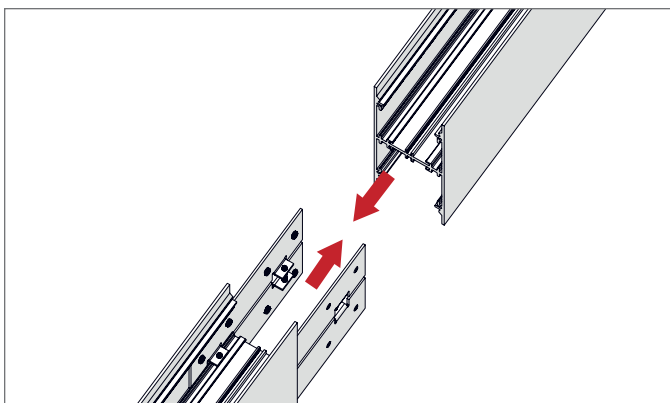

6 Connecting Multiple Sections (If Necessary)

Please see steps 12 through 25 for directions on connecting multiple sections.

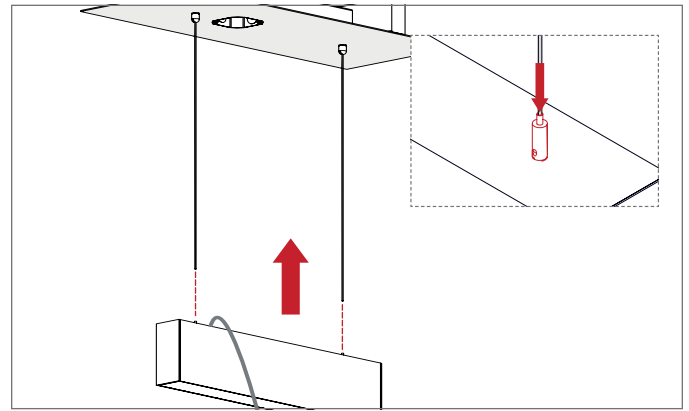

7 Raise Fixture to Suspension Cables

Raise fixture to Suspension Cables, and attach fixture by inserting Suspension Cable through Cable Grippers.

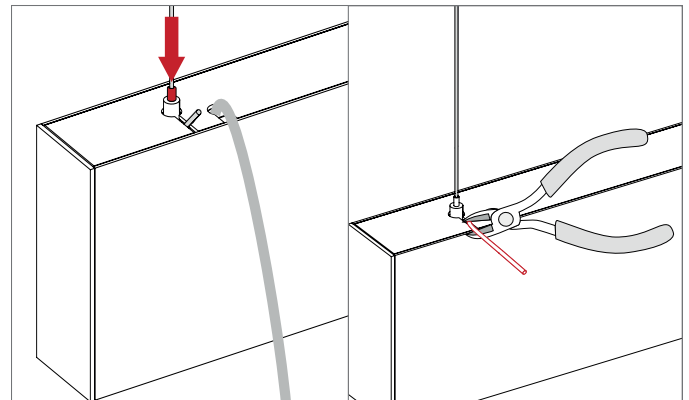

8 Adjust Suspension Cable Length

Adjust fixture until it is level and at desired height. Depress top of Cable Gripper to lower fixture. Keep fixture supported while lowering. Cut excess cable.

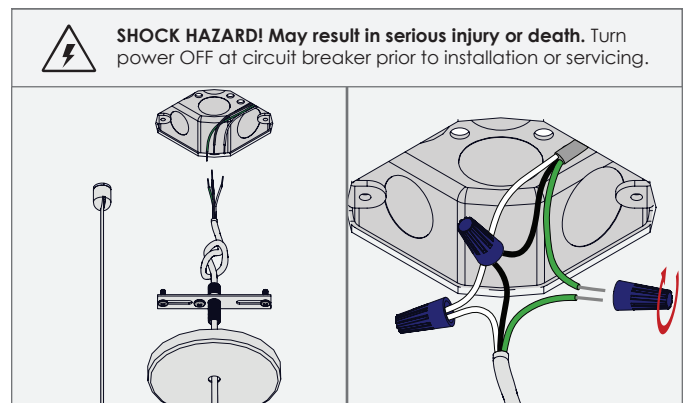

9 Connect High Voltage Wiring

Bring wiring and canopy assembly to J-box. Refer to page 11 and final/record drawing to make wiring connections.
CAUTION: High Voltage Wire — Ensure Power is OFF prior to connecting wiring.

Installation: Standard Suspension (Cont.)



DO NOT PINCH OR PUT EXCESSIVE TENSION ON WIRES while installing canopy.

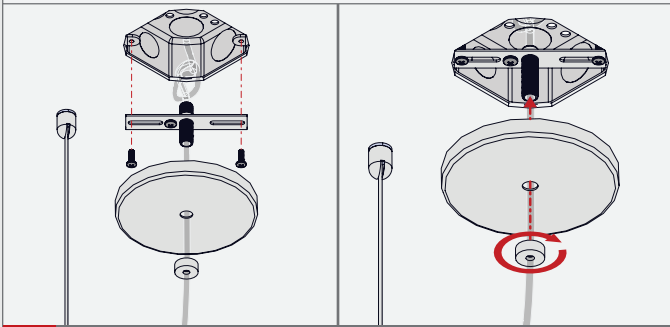

10A Mount Canopy Bracket to J-Box & Secure Canopy

Mount Canopy Bracket to J-Box using provided screws, then secure Canopy over J-Box with finial. **CAUTION: Do not pinch wire connections.**



DO NOT PINCH OR PUT EXCESSIVE TENSION ON WIRES while installing canopy.

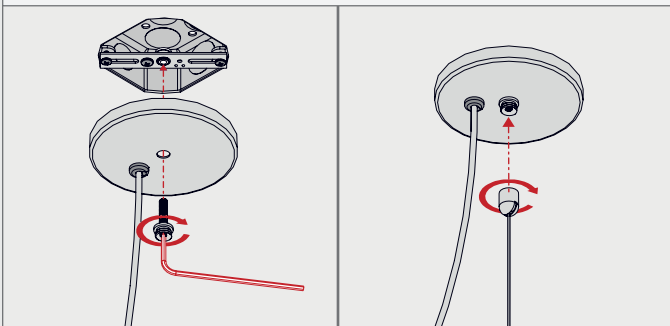

10B Combo Canopy Installation

Mount Canopy Bracket to J-Box using appropriate mounting hardware, then secure Canopy over J-Box with Ceiling Fitting using 1/8" Allen Key. Attach bullet (with cable) to canopy. **CAUTION: Do not pinch wire connections.**

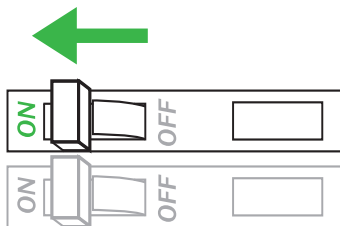

11 Turn Power On

Turn breaker ON and check if fixture operates as intended and that there are no loose connections.

Installation: Connecting Multiple Sections

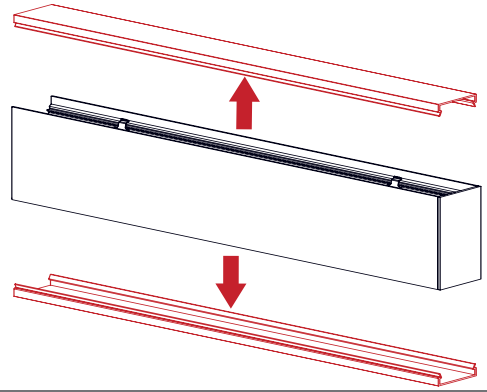

12 Remove Lenses

Carefully remove direct and indirect lenses using suction cup or similar. **NOTE: Cover is provided if lamping is not selected.**

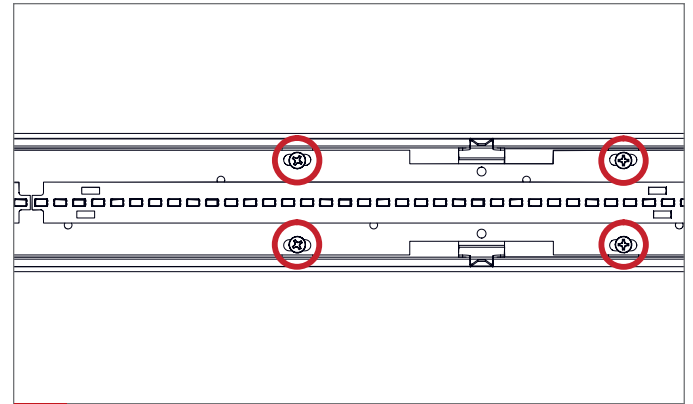

13 Remove Heatsink/Reflector Screws

Remove Heatsink/reflector screws that attach to housing. Set aside.

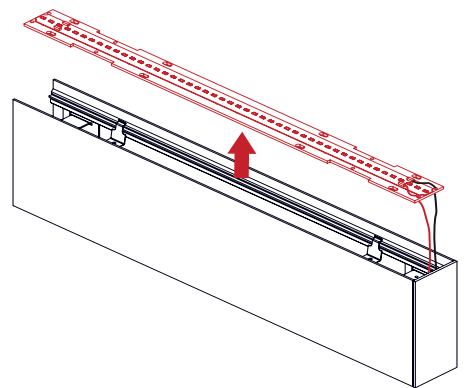

14 Remove Heatsink/Reflector

Remove Heatsink/reflector and hang over side of fixture. Same step for Indirect (if necessary)

CAUTION: Do not apply excessive tension to wires!

Installation: Connecting Multiple Sections (Cont.)

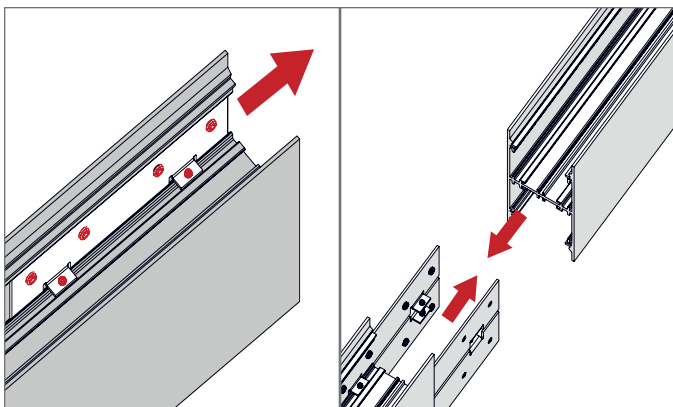

15 Align and Join Sections Together

Loosen set screws and slide out joiner bracket halfway to allow for joining. Join sections together, as shown, ensuring correct alignment. See final/record drawing for more details. **CAUTION:** Do not pinch wires while joining!

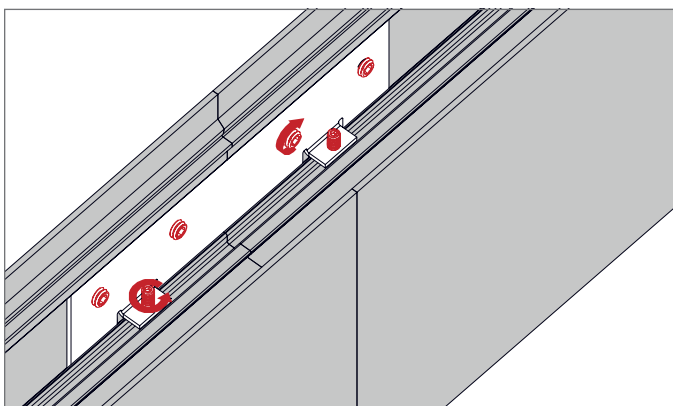

16 Tighten Joiner Set Screws

Tighten joiner set screws, as shown, using a 5/64" hex key for the sides and a 1/8" hex key for the bottom. Ensure each section is properly aligned, and that there are no gaps between sections.

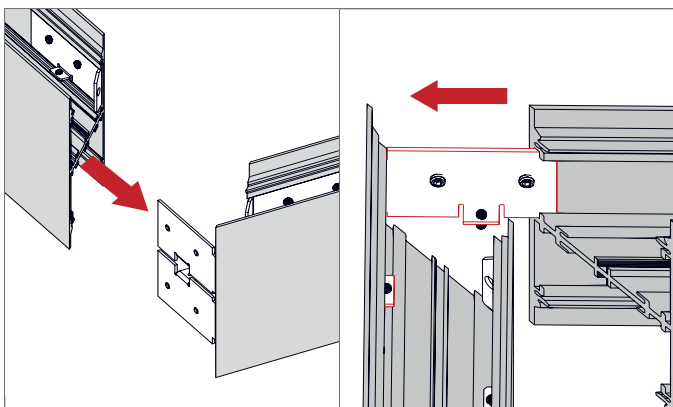

17 Mitered Corners: Join Sections

Join sections together, as shown, ensuring correct alignment. See final/record drawing for more details. **CAUTION:** Do not pinch wires while joining!

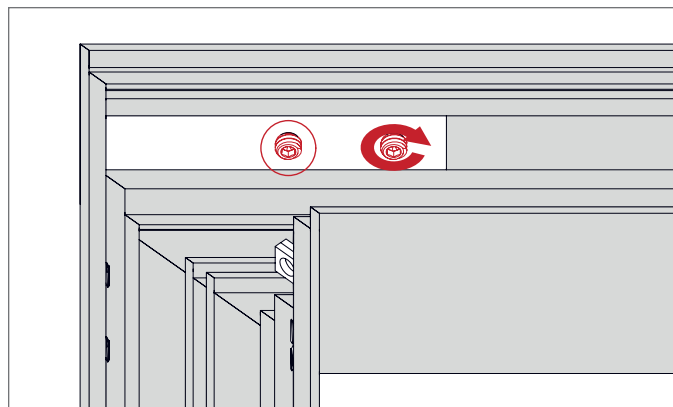

18 Tighten Set Screws on Outer Corner

Tighten set screws to secure outer corner bracket to joined section using a 1/8" hex key. Ensure each section is properly aligned and that there are no gaps between sections.

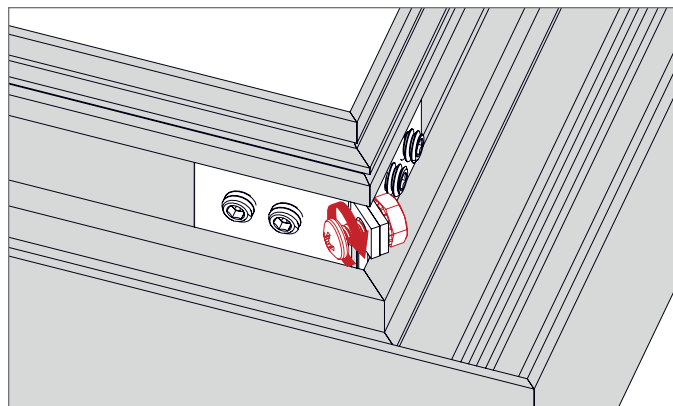

19 Tighten Joiner Screws on Inner Corner

Tighten joiner screws, as shown. Ensure each section is properly aligned, and that there are no gaps between sections.

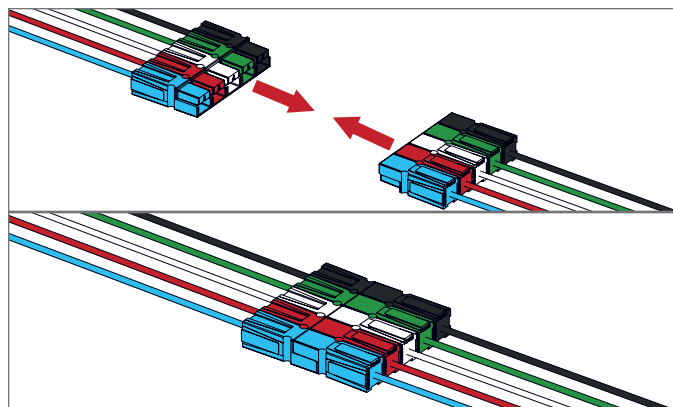

20 Connect Wiring Between Sections

Connect wiring quick-connects between sections. Match each color, as shown. **NOTE:** Color combinations may vary.

Installation: Connecting Multiple Sections (Cont.)



SHOCK HAZARD! May result in serious injury or death. Turn power OFF at circuit breaker prior to installation or servicing.



DO NOT PINCH OR PUT EXCESSIVE TENSION ON WIRES while joining sections or reattaching heatsink.

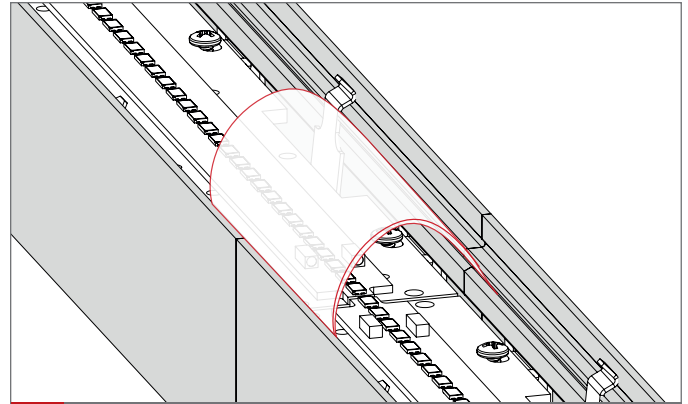

23 Install Diffuser Shim

Install Diffuser Shim at each joined location to prevent light leak between lens sections. Re-install at endcap locations, as necessary.

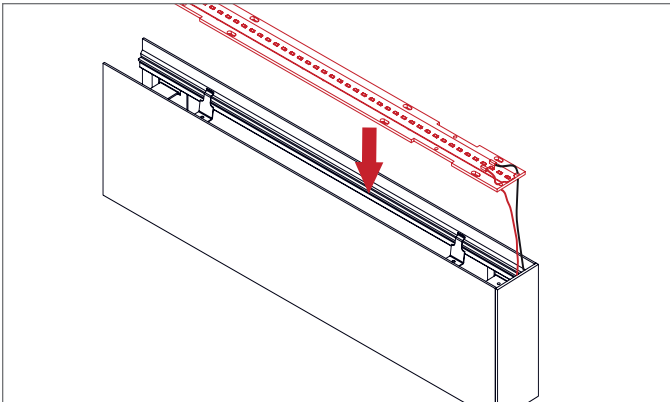

21 Re-install Heatsink/Reflector

Re-install each Heatsink/reflector section. **CAUTION: Do not pinch wires while reattaching!**

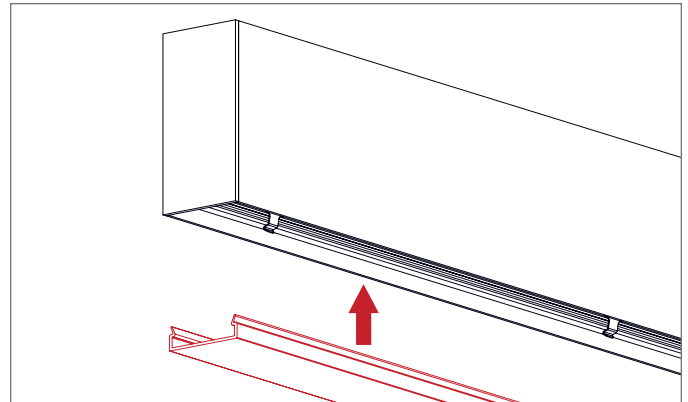

24 Re-install Lens

Carefully re-install lens, ensuring lens sits properly within Lens Clips.

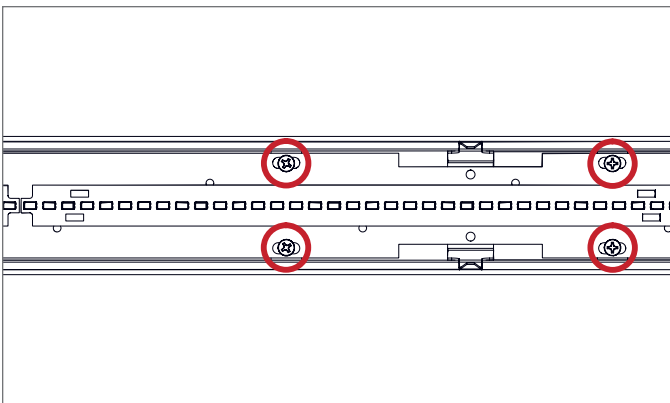

22 Re-install Heatsink/Reflector Screws

Re-install Heatsink/reflector screws to attach back to housing.

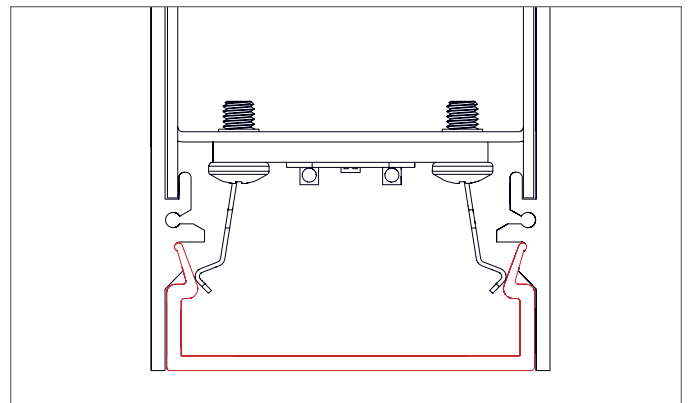

25 Ensure Lens Sits Properly Between Lens Clips

Ensure the lens is properly installed between the Lens Clips.

Wiring Diagrams

Traditional On/Off

