

CONTENTS

01 Components

02 Installation

Surface mounted

Recessed mounted

03 Cutting

04 Recommended strips and power supplies

05 Applications

06 Precautions

Fixture maintenance

Warranty

Q&A

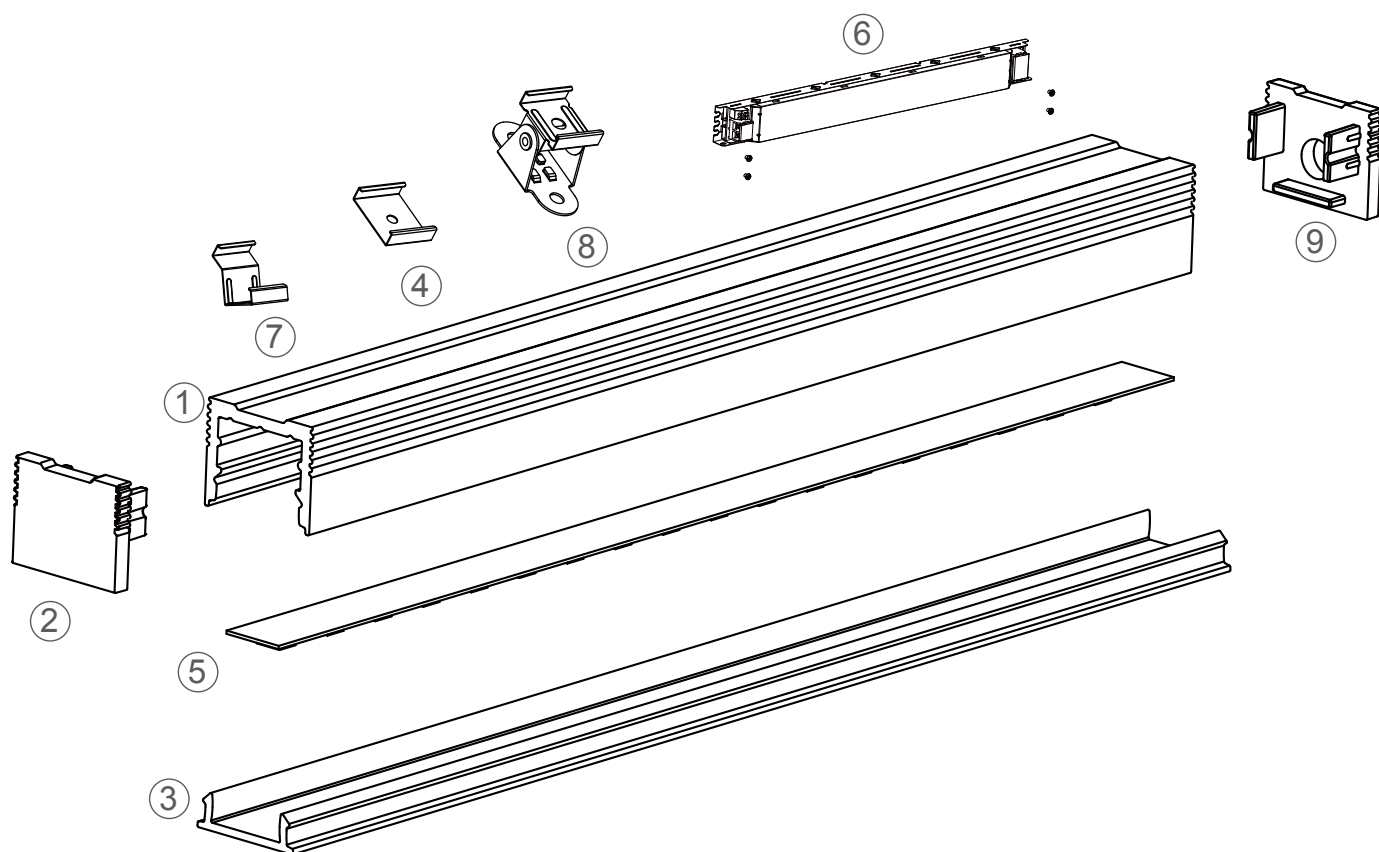

Essential

- ① Profile x1
- ② End cap x4
- ③ Diffuser x1
- ④ 90° Mounting clip x8

Installation accessories *

- ⑦ clips
- ⑧ 180° adjustable clip

Lighting Source and Power Supply *

- ⑤ Flexible strip
- ⑥ Power supply

Others *

- ⑨ End cap with hole

* Optional parts

Installation

Surface mounted

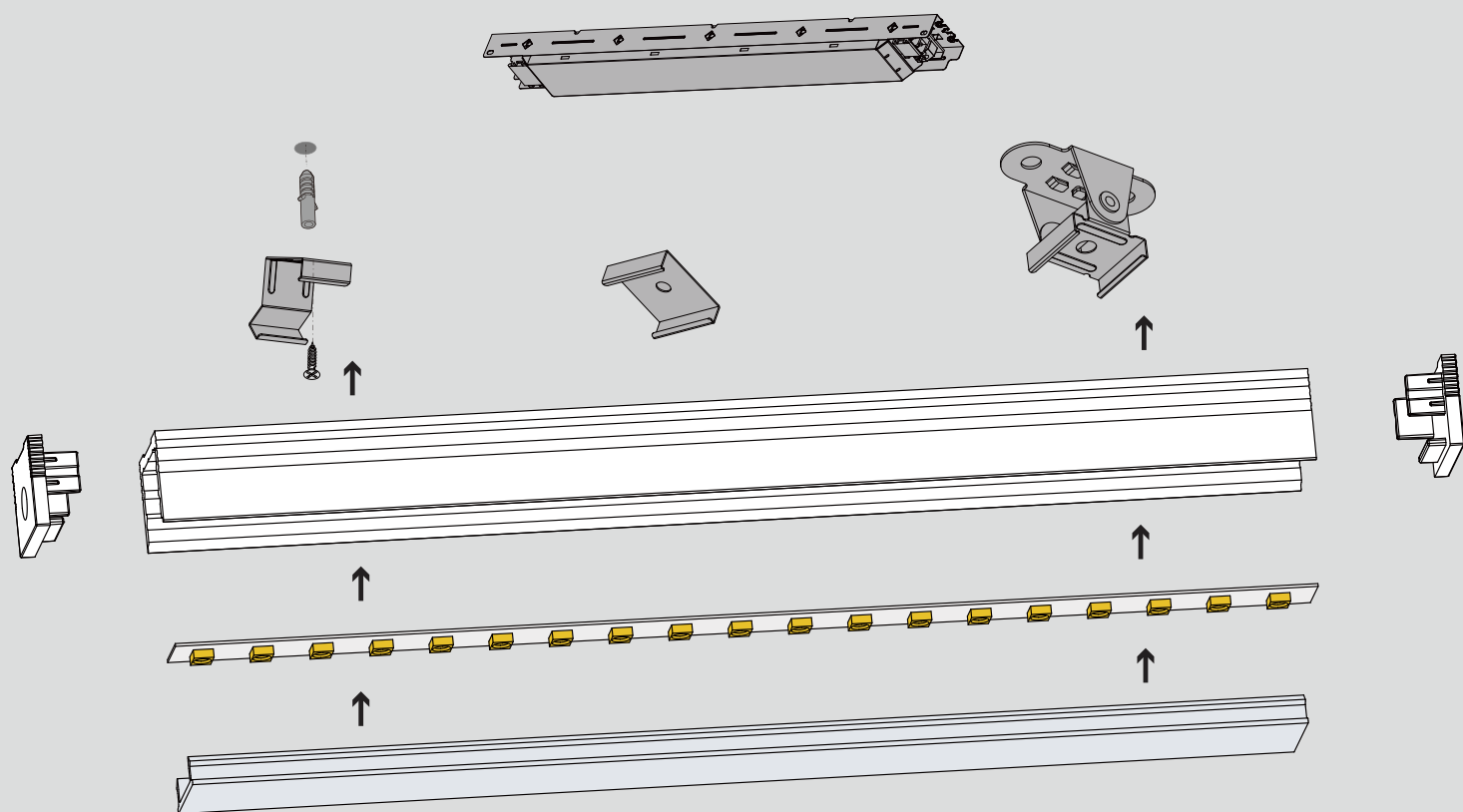

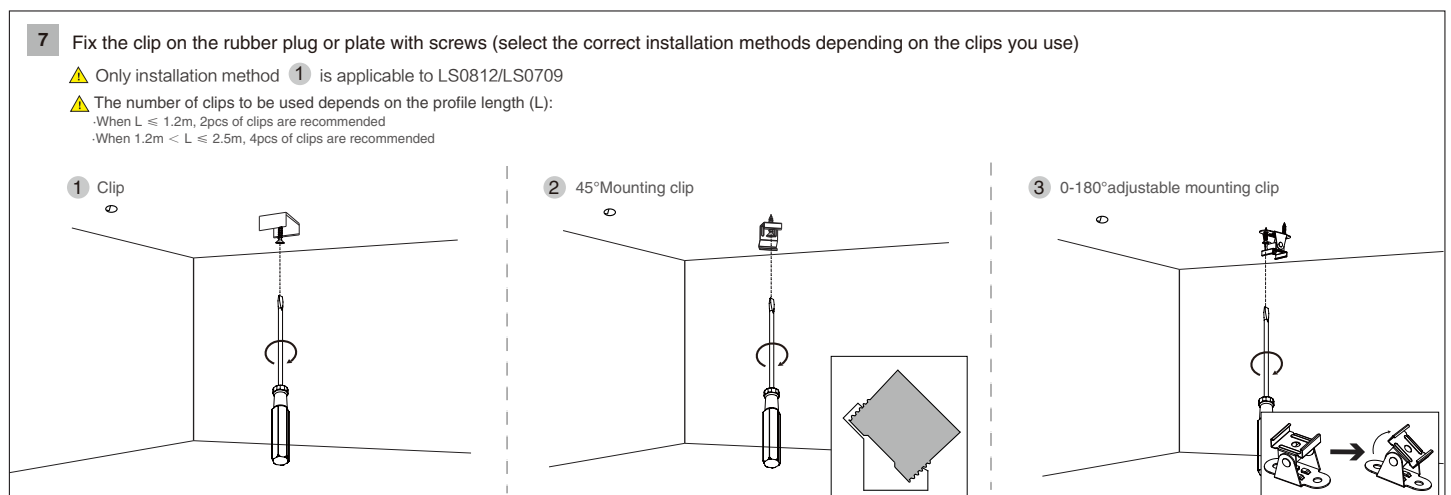
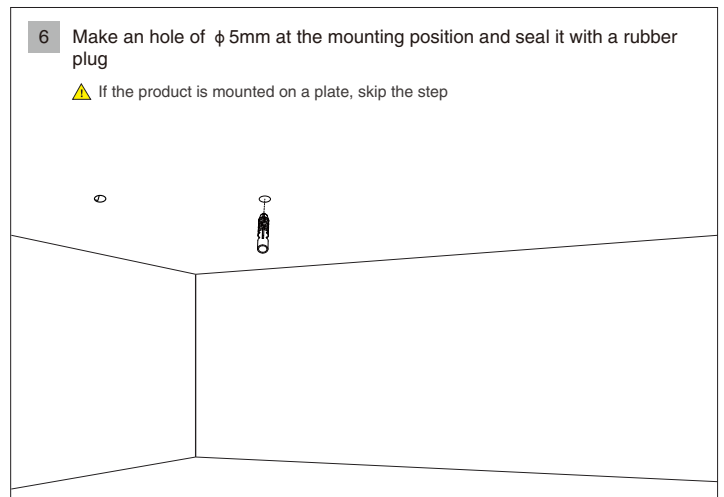
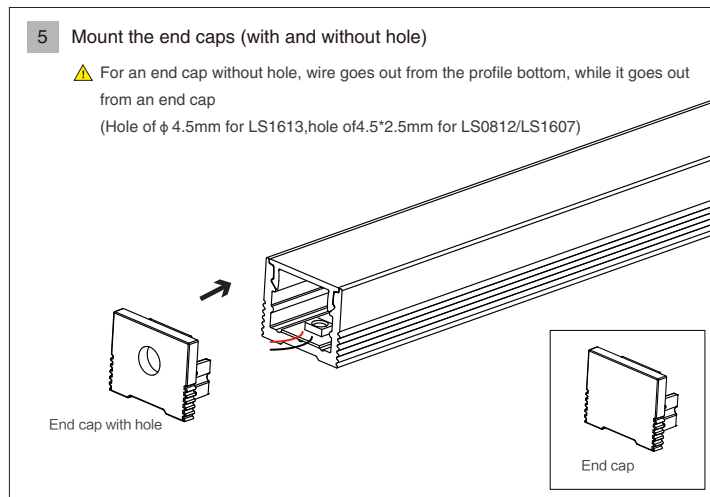
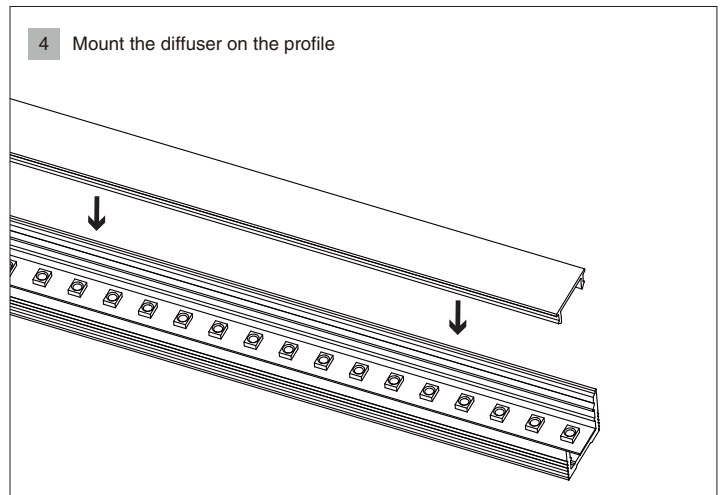
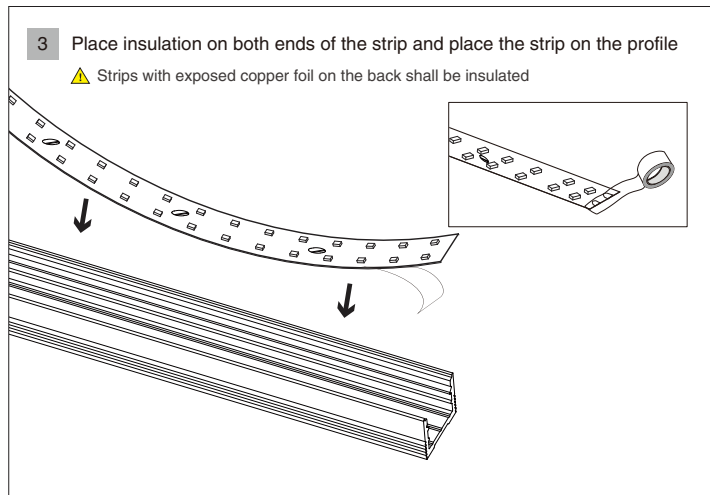
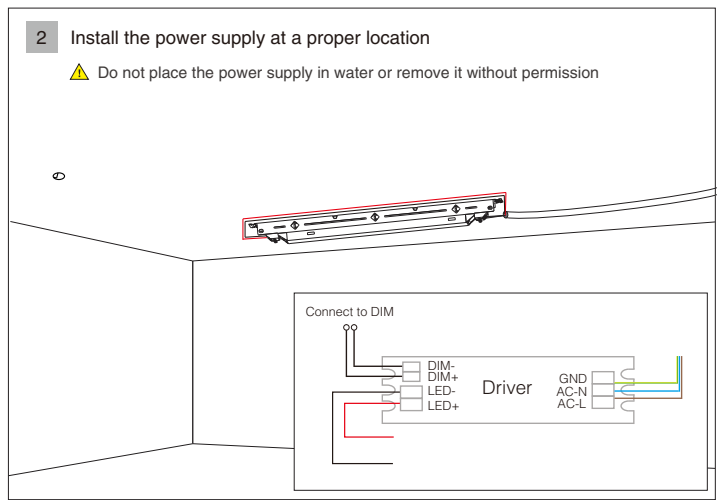
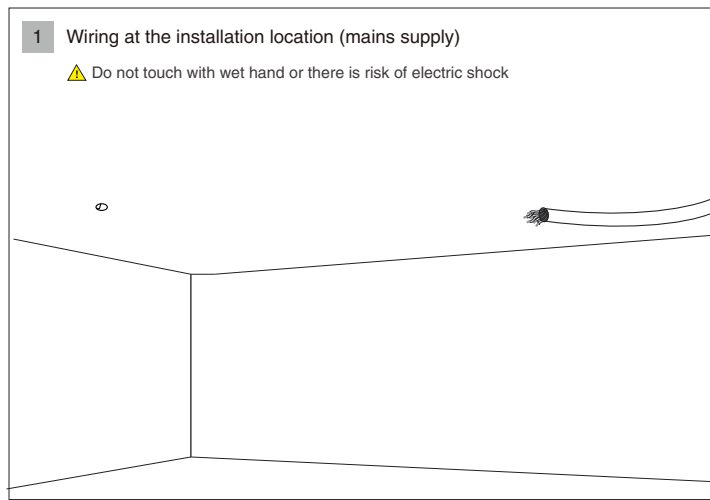

- 8 Fix the profile at the mounting position, Connect the strip wire in the profile with the output line of the power supply

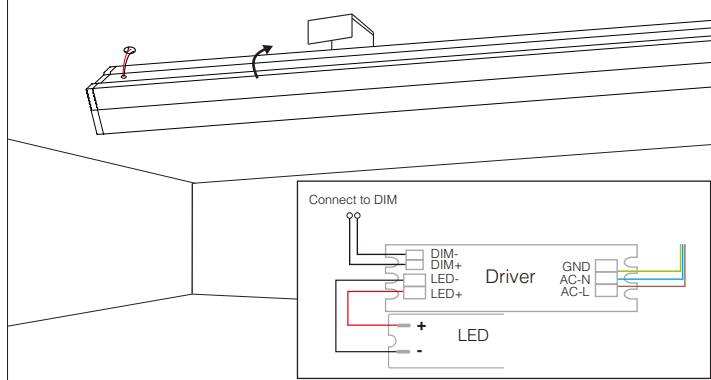

- 9 Completed

⚠ When smoke or the smell of burning is found from the fixture, please immediately turn it off

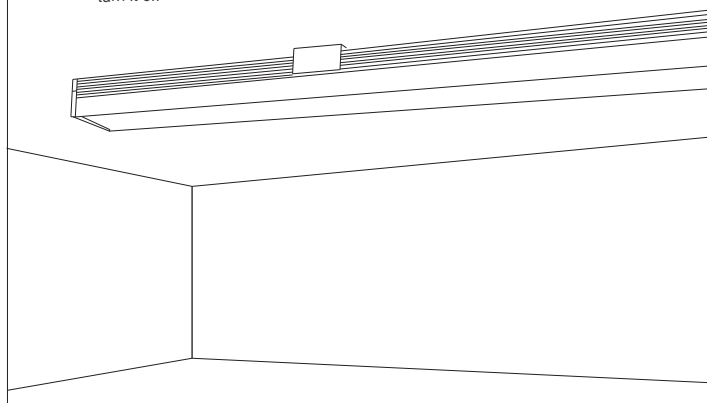

Installation

Recessed

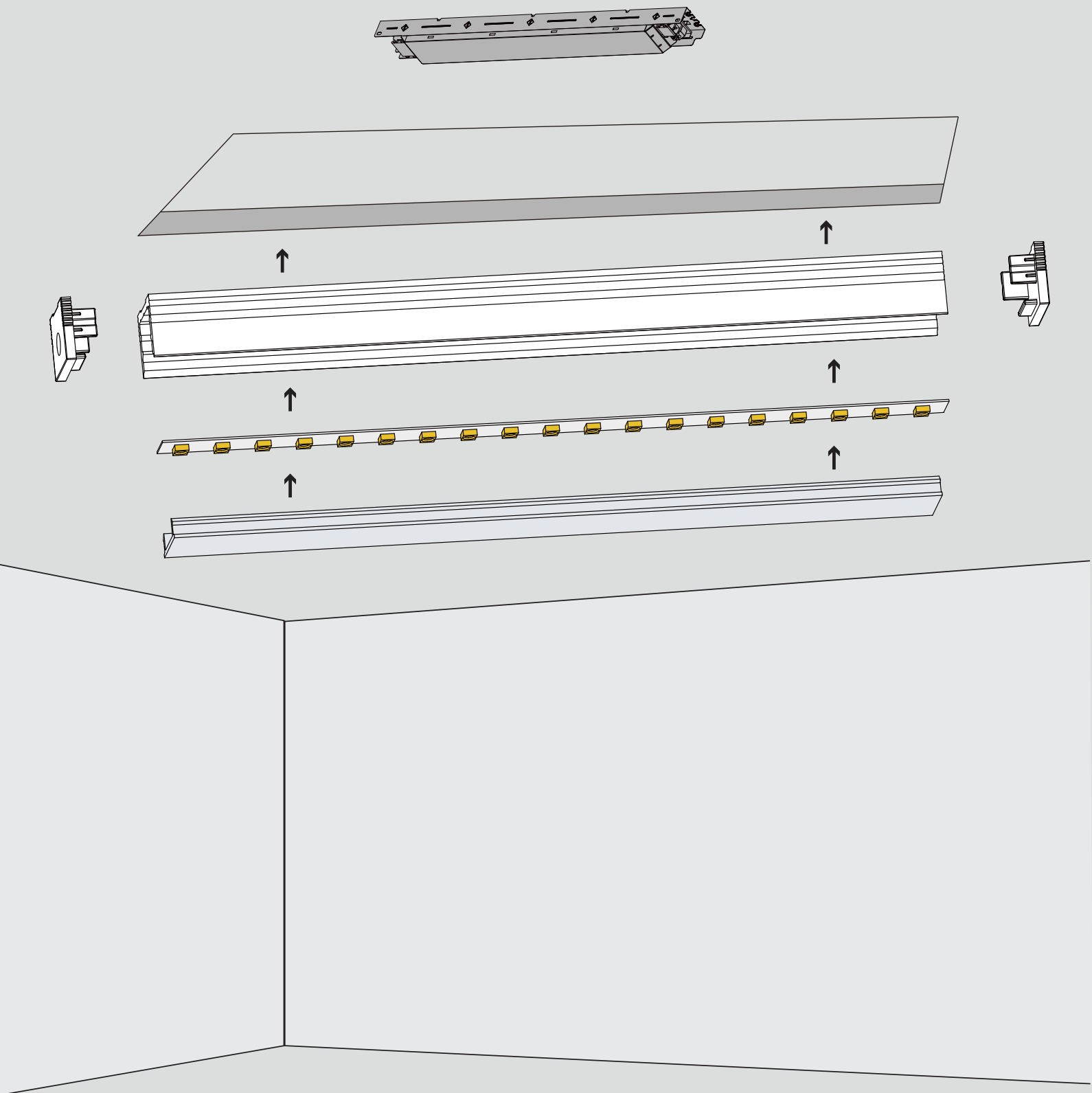

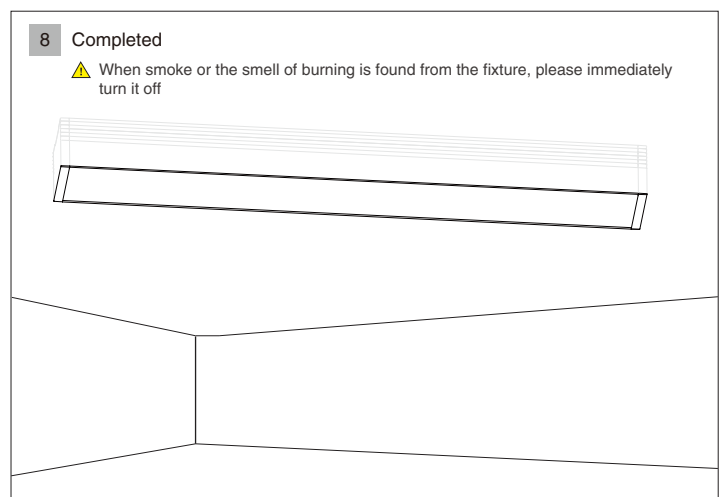
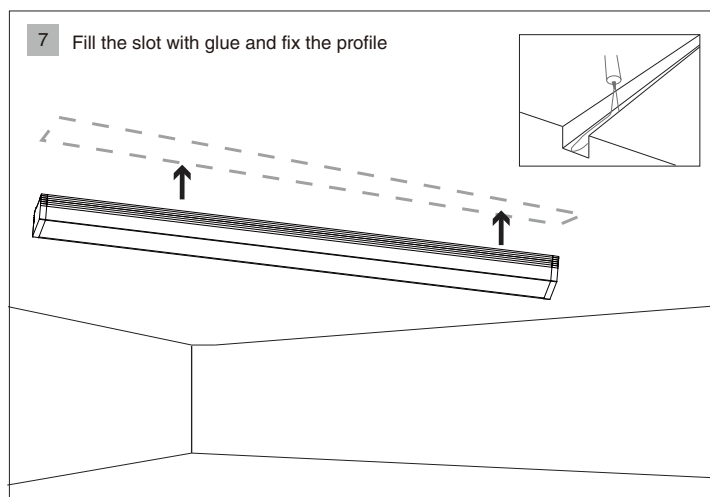
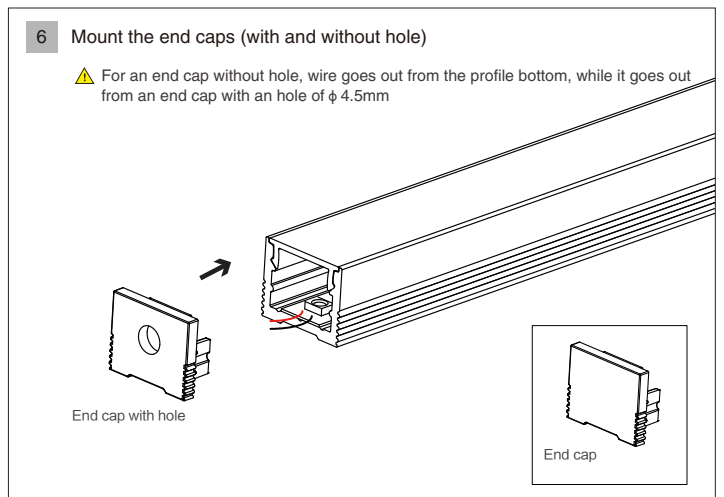
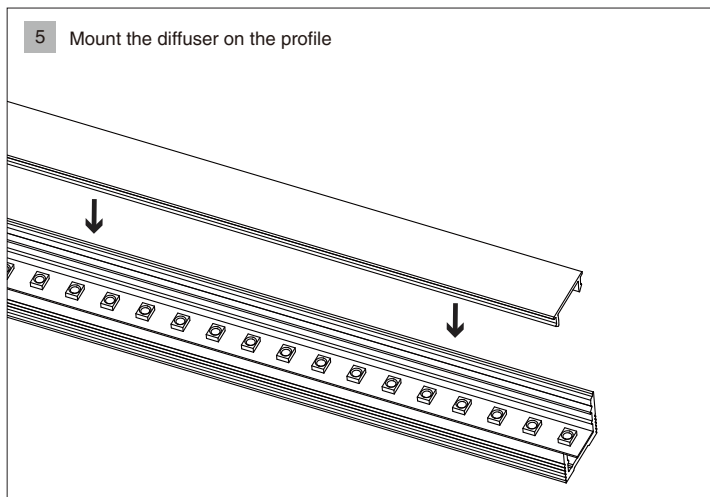
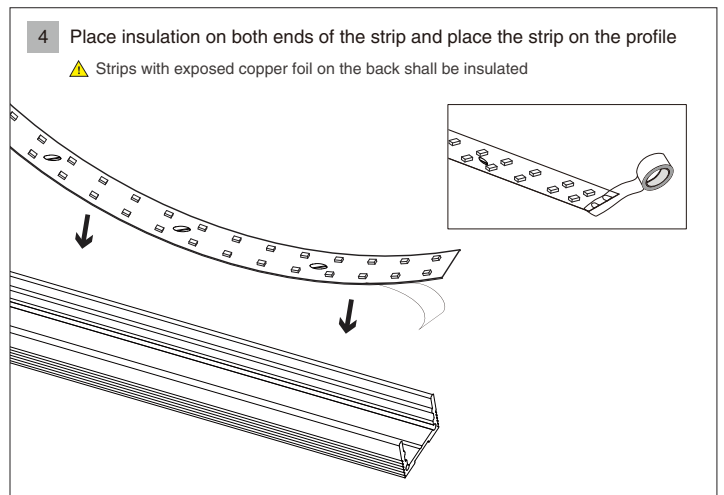
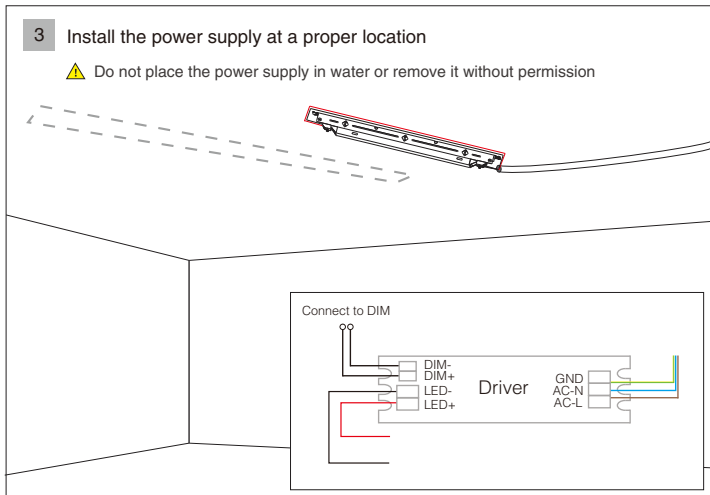
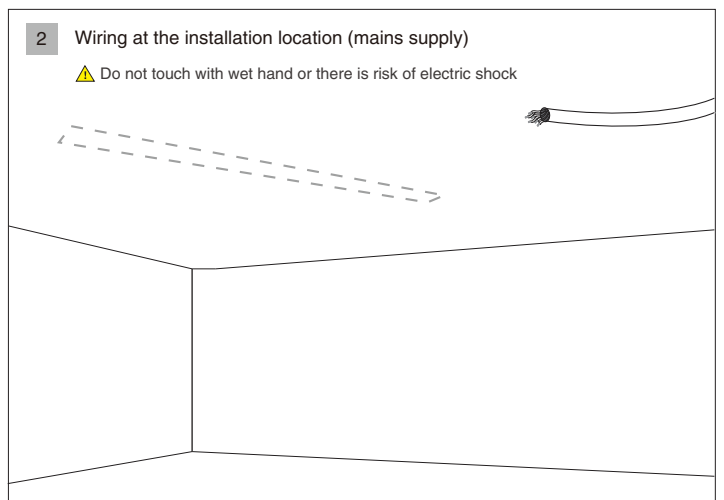
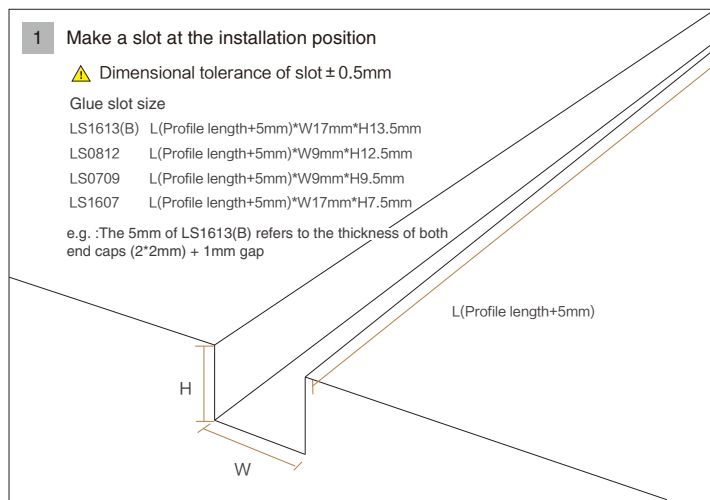

cutting

1 Mount the diffuser on the profile

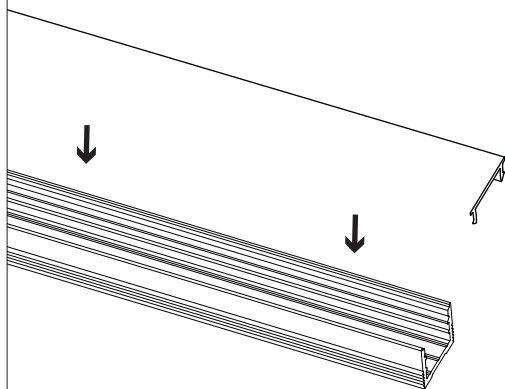

2 Mark the length to the cut off (profile loss will occur during cutting by about the thickness of the blade), and please make reservations of profile length

⚠ When the wire goes out from the profile bottom and end cap, the length to be cut off is a multiple of the minimum cutting unit of the strip + wire length going out (For LS1613(B)\LS1607 8mm wire will be led out, and 10mm for LS0812, and 15mm for LS0709)

⚠ For LS0709 the single-end diffuser is shorter than the profile by 3mm

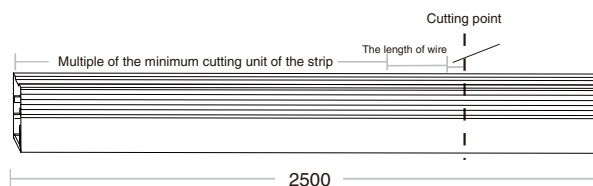

3 Profile cutting by a cutting machine

⚠ It is recommended to set the speed at 1,000 – 1,200rpm. Too high a speed may cause damage to the diffuser

⚠ A light source is not slowed to be placed on the profile during cutting

⚠ Please make sure the product is firmly fixed during cutting. The break shall be ground smooth to remove burr after cutting, and metal chips shall be completely removed from inside the track

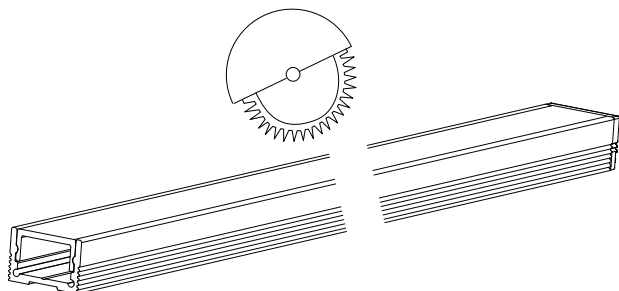

4 Cut the strip to match the profile and weld the red and black wire on one end of the strip

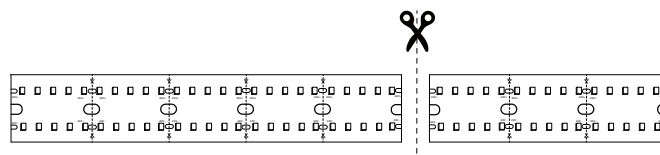

5 When the wire goes out from the end cap, it is unnecessary to make an hole in the profile. When it goes out from the profile bottom, an hole is to be made, as shown in the figure below

⚠ The hole for outgoing wire has a diameter of 5mm for LS0812, and 8mm for LS1613\LS1607\LS0709

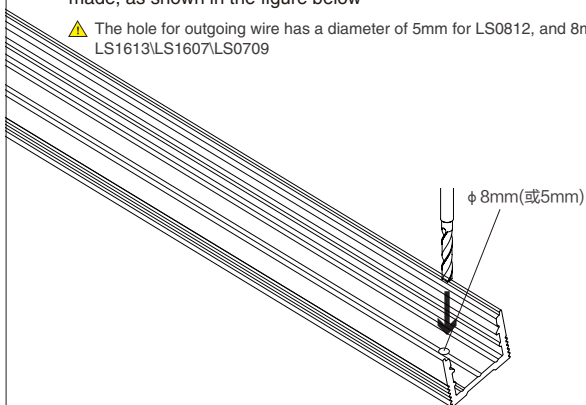



Precautions

Recommended practice for fixture storage and maintenance

- 1、The storage site shall be dry, clean and well ventilated;
- 2、Shelves or cabinets shall be provided for fixture storage;
- 3、Proper fire prevention measure shall be provided;
- 4、Fixtures (including accessories) shall be managed and stored by type and properly marked;
- 5、The supplied user manuals and packing boxes of fixtures, accessories and light sources shall be properly maintained for future reference;
- 6、Fixtures shall be regularly wiped and maintained;
- 7、Clean and soft cloth shall be used to wipe fixtures;
- 8、Do not wash fixtures with water.

Notes on product warranty

- 1、A warranty period of three years is provided for products in normal use. For any faults arising during the period that are confirmed to be quality related by inspection of the company, a product of the same model will be replaced for free.
- 2、The warranty does not cover any of the following:
 - (1) Any product damage due to usage not allowed in the instructions;
 - (2) Any product damage due to disassembling or wrong operations by the user;
 - (3) Severe appearance damage or deformation of the product;

Q&A

Q Some parts in the fixture are not lit.

A Please remove the diffuser and check whether the LED strips are not functioning. If any, please replaced them.

Q The whole fixture is not lit.

A Please check for abnormalities at the input and output of the power supply or reversion of the LED strip. If there is none, it is recommended to replace the power supply.

Q The fixture flashes.

A Please check for poor contact of the input and output connections of the power supply. If there is none, please carefully check whether the power supply is over-loaded. If not, it is recommended to replace the power supply.

Q Dimming is not possible for an installed fixture.

A Please check the dimming circuit of the power supply for any abnormality or fault in the dimmer. If none, it is recommended to replace the power supply.

Q For two fixtures of the same type, one is darker than the other.

A Please check for over-load of the power supply. If not, it is recommended to replace the power supply.

Q The diffuser breaks after cutting.

A Please check the speed of the cutting machine. Too high a speed tends to cause breaking of the diffuser. It is recommended to set the speed to 1,000 – 1,200rpm.

Q The cut surface is not flat after profile cutting.

A Please check for severe wearing of the blade of the cutting machine. If any, it is recommended to replace with a new blade.

Q Light leak is found during lighting up after assembling.

A Please check the levelness of the installation. If there is any problem, adjust the levelness and assemble again. If the levelness is Ok, please check verticality of the cut surface.

Q Light leak from the end cap is found after lighting up.

A Please check consistency between the length of profile and the diffuser and flatness of the cut surfaces of the profile and the diffuser.

Q Worn thread of the cap screws.

A Please check whether proper torque is used to fasten the screws (M2.0*8mm self-tapping screws for the end caps). It is recommended that the torque may not exceed 0.2N/m (about 2.0Kgf/cm).

Q Black areas are found on both ends.

A Please check whether the distance between the strip and the end cap exceeds 6mm. If it does, please adjust profile length.